

# CERTIFICATE OF LOCATION OF GOVERNMENT CORNER

**NORTHEAST** Corner of Section 12, Township 105 N, Range 39 W, 5<sup>th</sup> P.M.

STATE OF MINNESOTA, County of MURRAY

At the corner location shown on the sketch:

On 1-22-76 found a 2 1/2" x 2 1/2" IRON BAR, DOWN 0.5'  
DATE

left monument as found,  lowered monument,  removed monument (explain)

On \_\_\_\_\_ placed a \_\_\_\_\_  
DATE

### SKETCH OF REFERENCE TIES

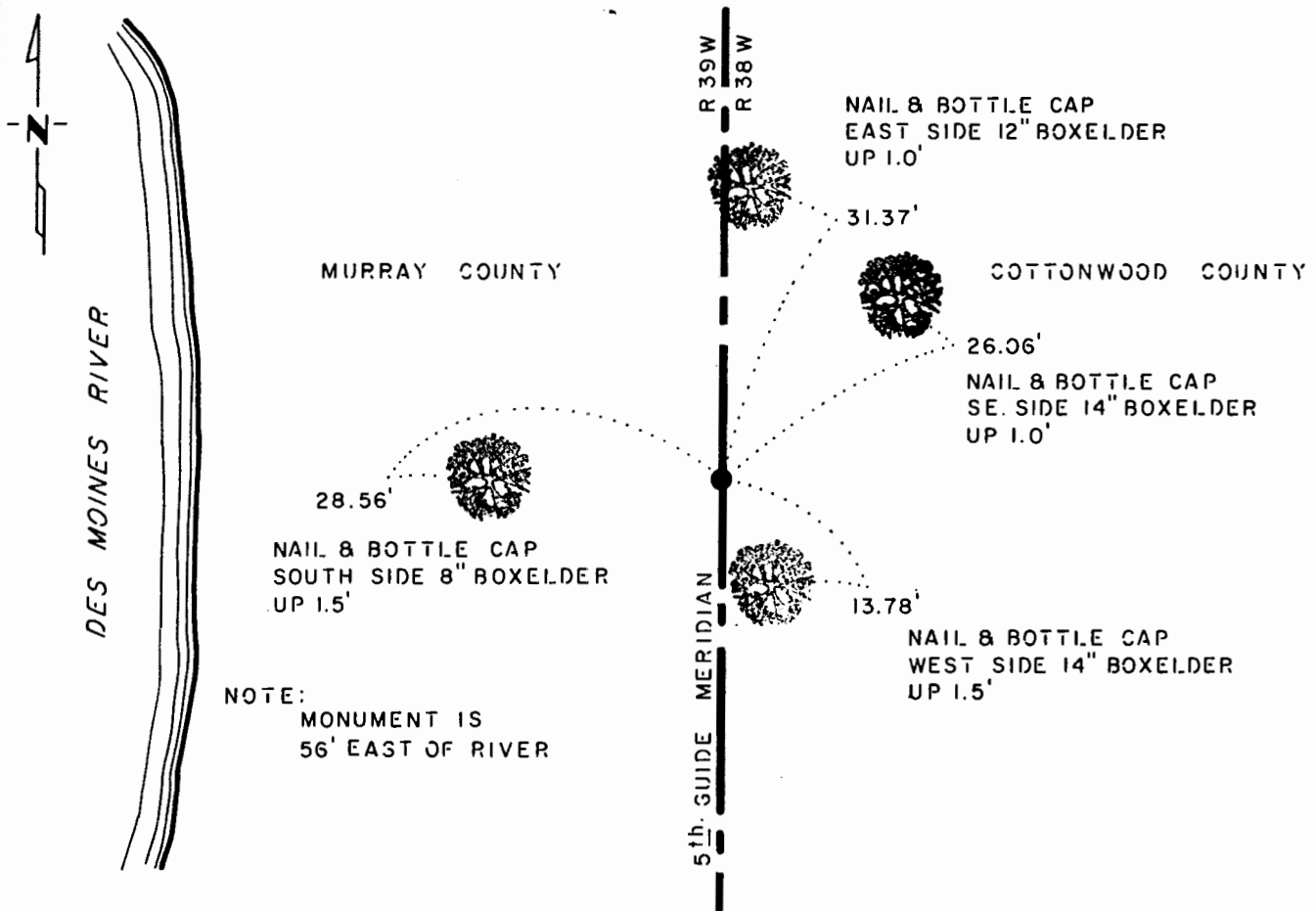

NOTE:  
MONUMENT IS  
56' EAST OF RIVER

Statement of evidence relative to this corner location is on back of page.

J.B.M. 3-20-85  
G-158

I hereby certify that this document and the data contained herein was prepared by me or under my direct supervision.

Bruce W. Shepard 12/20/85  
SIGNATURE DATE

Registration No. 17003

Land Surveyor,  Professional Engineer

County Surveyor,  County Engineer

### OFFICE OF THE COUNTY RECORDER

County of \_\_\_\_\_

I hereby certify that this document was filed in the Co. Recorders office at \_\_\_\_\_ .M. on the \_\_\_\_\_ day of \_\_\_\_\_ A.D., 19 \_\_\_\_\_

County Recorder \_\_\_\_\_

By \_\_\_\_\_, Deputy

DOCUMENT NO. \_\_\_\_\_

Northeast Corner Section 12, Township 105 North, Range 39 West

This corner was originally established by the U. S. General Land Office survey in 1857. The government notes show:

set post, deposited charcoal, made mound, trench, and pits and planted plum seed northeast and southwest

In October 1975, the DNR Bureau of Engineering contacted the following for corner information:

Cottonwood County Offices of the Recorder and Highway Engineer  
Murray County Offices of the Recorder and Highway Engineer  
Sioux Engineering of Windom

The following information was obtained from the Cottonwood County Recorder's Office:

Plat 49 contains a resurvey of Township 105 North, Range 38 West done by C. W. Gove, County Surveyor, in 1898. Plat shows that corner was established:

2641.25 feet from the east quarter corner of Section 1

2641.25 feet from the east quarter corner of Section 12

A 2½" by 2½" by 30" cast iron stake was set to mark this location.

In January 1976, the DNR Bureau of Engineering traversed to the area of the corner and found a 2½" by 2½" iron bar. The iron bar was found to be 2638.58 feet from the east quarter corner of Section 1.

Accept the iron bar as the location of the corner.

Traverse information is available from the DNR Bureau of Engineering.

79hah